



Table of Contents

Colored Lenses	11-2
Colored Lenses with Seal	11-2
Pilot Indicators	11-3
Emergency Off Push Button Switch	11-3
Illuminated Push Button Switches	11-4, 11-5
Pilot Indicator - 22mm Solder Type	11-6 to 11-8
Accessories	11-9
Technical Specifications	11-10

Colored Lenses - 16mm

Round



Tyco Part Number	1478623-6	1478623-5	1478623-4	1478623-3	1478623-2	1478623-1
Lens Colors Available	Yellow	Clear	Red	Orange	Green	Blue

Square



Tyco Part Number	1478622-6	1478622-5	1478622-4	1478622-3	1478622-2	1478622-1
Lens Colors Available	Yellow	Clear	Red	Orange	Green	Blue

Rectangular



Tyco Part Number	1478621-6	1478621-5	1478621-4	1478621-3	1478621-2	1478621-1
Lens Colors Available	Yellow	Clear	Red	Orange	Green	Blue

Colored Lenses with Seal - 22mm Lens for 25mm & 29mm Bezels

Lens for 25mm Bezel



Tyco Part Number	1478624-6	1478624-5	1478624-4	1478624-3	1478624-2	1478624-1
Lens Colors Available	Yellow	Clear	Red	Orange	Green	Blue

Lens for 29mm Bezel



Tyco Part Number	1478625-6	1478625-5	1478625-4	1478625-3	1478625-2	1478625-1
Lens Colors Available	Yellow	Clear	Red	Orange	Green	Blue

Pilot Indicators - 16mm Solder Type

Round



Lens supplied separately.
See page 2 for color options



Tyco Part Number 1478634-1

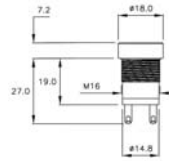

Panel Cut Out Details

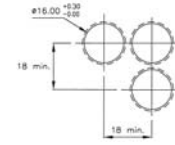

Square



Lens supplied separately.
See page 2 for color options



Tyco Part Number 1478631-1

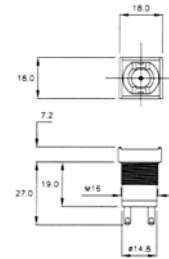

Panel Cut Out Details

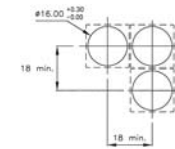

Rectangular



Lens supplied separately.
See page 2 for color options



Tyco Part Number 1478628-1

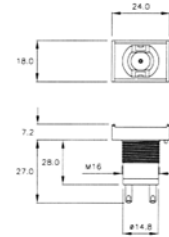

Panel Cut Out Details

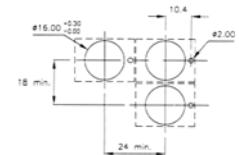

Emergency Off Push Button Switch - 16mm Solder Type

Round

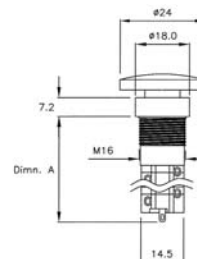

Panel Cut Out Details

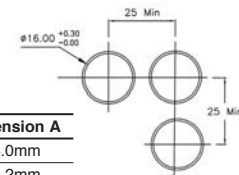

Type	Dimension A
3 Pole	44.0mm
2 Pole	36.2mm
1 Pole	28/5mm

Action	Momentary			Alternate		
Contact Option	SPST* - 1 Pole	DPST* - 2 Pole	3PST* - 3 Pole	SPST* - 1 Pole	DPST* - 2 Pole	3PST* - 3 Pole
Tyco Part Number	1478765-1	1478765-2	1478765-3	1478766-1	1478766-2	1478766-3

Illuminated Push Button Switches - 16mm Socket Type

Round



Lens supplied separately.
See page 2 for color options



Kit supplied with washer,
lock nut, and contact cover

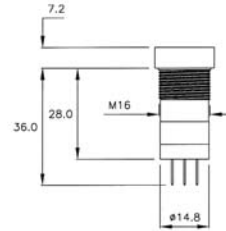

Panel Cut Out Details

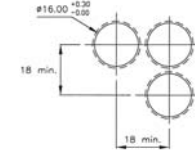

Action	Momentary	Alternate
Tyco Part Number	1478639-1	1478640-1

Square



Lens supplied separately.
See page 2 for color options



Kit supplied with washer,
lock nut, and contact cover

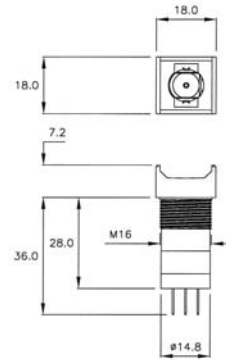

Panel Cut Out Details

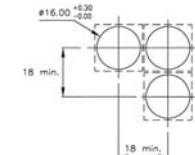

Action	Momentary	Alternate
Tyco Part Number	1478637-1	1478638-1

Rectangular



Lens supplied separately.
See page 2 for color options



Kit supplied with washer,
lock nut, and contact cover

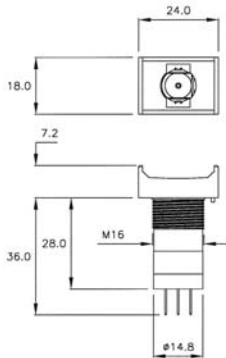

Panel Cut Out Details

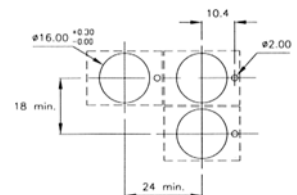

Action	Momentary	Alternate
Tyco Part Number	1478635-1	1478636-1



Illuminated Push Button Switches - 16mm Solder Type

Round



Lens supplied separately.
See page 2 for color options



Kit supplied with washer,
lock nut, and contact cover

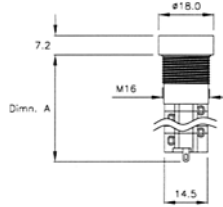

Panel Cut Out Details

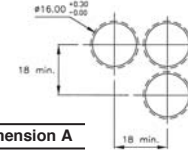

Type	Dimension A
3 Pole	44.0mm
2 Pole	36.2mm
1 Pole	28/5mm

Action	Momentary			Alternate		
Contact Option	SPST* - 1 Pole	DPST* - 2 Pole	3PST* - 3 Pole	SPST* - 1 Pole	DPST* - 2 Pole	3PST* - 3 Pole
Tyco Part Number	1478632-1	1478632-2	1478632-3	1478633-1	1478633-2	1478633-3

Square



Lens supplied separately.
See page 2 for color options



Kit supplied with washer,
lock nut, and contact cover

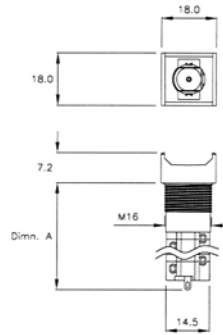

Panel Cut Out Details

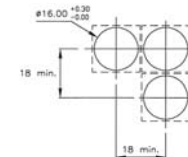

Type	Dimension A
3 Pole	44.0mm
2 Pole	36.2mm
1 Pole	28/5mm

Action	Momentary			Alternate		
Contact Option	SPST* - 1 Pole	DPST* - 2 Pole	3PST* - 3 Pole	SPST* - 1 Pole	DPST* - 2 Pole	3PST* - 3 Pole
Tyco Part Number	1478629-1	1478629-2	1478629-3	1478630-1	1478630-2	1478630-3

Rectangular



Lens supplied separately.
See page 2 for color options



Kit supplied with washer,
lock nut, and contact cover

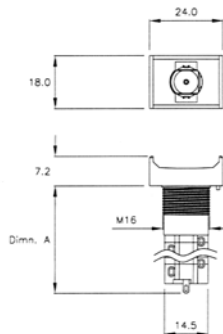

Panel Cut Out Details

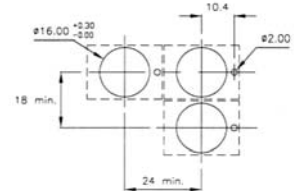

Type	Dimension A
3 Pole	44.0mm
2 Pole	36.2mm
1 Pole	28/5mm

Action	Momentary			Alternate		
Contact Option	SPST* - 1 Pole	DPST* - 2 Pole	3PST* - 3 Pole	SPST* - 1 Pole	DPST* - 2 Pole	3PST* - 3 Pole
Tyco Part Number	1478626-1	1478626-2	1478626-3	1478627-1	1478627-2	1478627-3

Pilot Indicator - 22mm Solder Type - 25mm & 29mm Bezel (Plastic/Metal)

25mm Bezel



Lens supplied separately.
See page 2 for color options



Kit supplied with washer,
lock nut, and contact cover

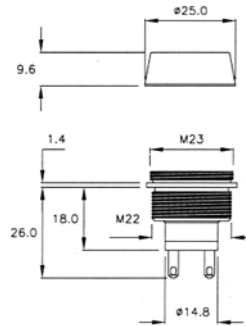

Panel Cut Out Details

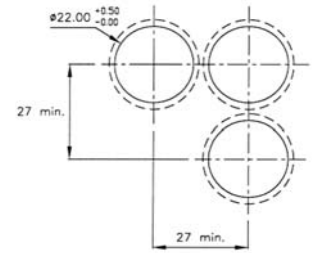

Contact Option	SPST*	
Bezel Option	Plastic	Metal
Tyco Part Number	1478649-1	1478643-1

29mm Bezel



Lens supplied separately.
See page 2 for color options



Kit supplied with washer,
lock nut, and contact cover

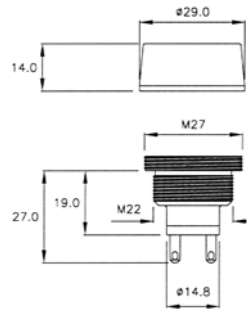

Panel Cut Out Details

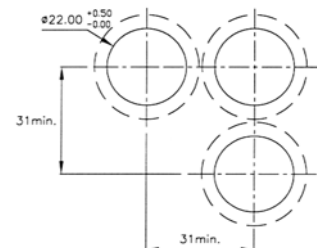

Contact Option	SPST*	
Bezel Option	Plastic	Metal
Tyco Part Number	1478652-1	1478646-1



Illuminated Push Button - 22mm Socket Type - 25mm & 29mm Bezel (Plastic/Metal)

25mm Bezel



Lens supplied separately.
See page 2 for color options



Kit supplied with washer,
lock nut, and contact cover

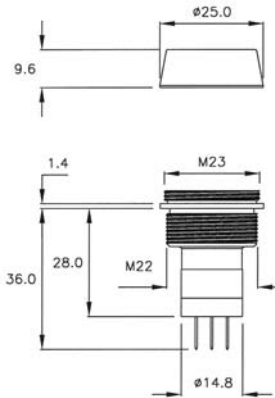

Panel Cut Out Details

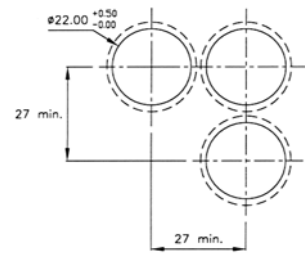

Contact Option	SPST*			
Action	Momentary		Alternate	
Bezel Option	Plastic	Metal	Plastic	Metal
Tyco Part Number	1478657-1	1478653-1	1478658-1	1478654-1

29mm Bezel



Lens supplied separately.
See page 2 for color options



Kit supplied with washer,
lock nut, and contact cover

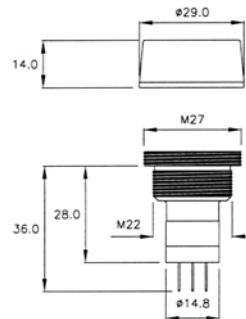

Panel Cut Out Details

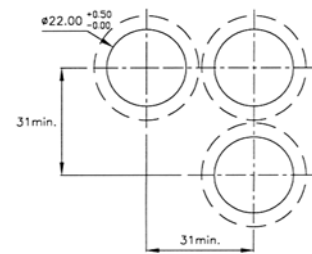

Contact Option	SPST*			
Action	Momentary		Alternate	
Bezel Option	Plastic	Metal	Plastic	Metal
Tyco Part Number	1478659-1	1478655-1	1478660-1	1478656-1

Illuminated Push Button - 22mm Solder Type - 25mm & 29mm Bezel (Plastic/Metal)

25mm Bezel



Lens supplied separately.
See page 2 for color options



Kit supplied with washer,
lock nut, and contact cover

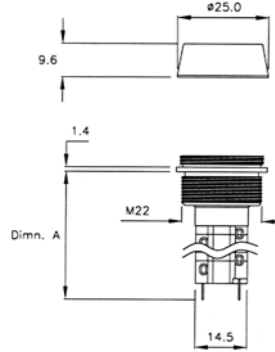

Panel Cut Out Details

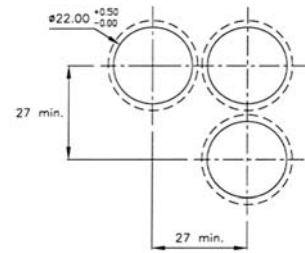

Type	Dimension A
3 Pole	44.0mm
2 Pole	36.2mm
1 Pole	28/5mm

Action	Momentary					
Bezel Option	Plastic			Metal		
Contact Option	SPST* - 1 Pole	DPST* - 2 Pole	3PST* - 3 Pole	SPST* - 1 Pole	DPST* - 2 Pole	3PST* - 3 Pole
Tyco Part Number	1478647-1	1478647-2	1478647-3	1478641-1	1478641-2	1478641-3

Action	Alternate					
Bezel Option	Plastic			Metal		
Contact Option	SPST* - 1 Pole	DPST* - 2 Pole	3PST* - 3 Pole	SPST* - 1 Pole	DPST* - 2 Pole	3PST* - 3 Pole
Tyco Part Number	1478648-1	1478648-2	1478648-3	1478642-1	1478642-2	1478642-3

29mm Bezel



Lens supplied separately.
See page 2 for color options



Kit supplied with washer,
lock nut, and contact cover

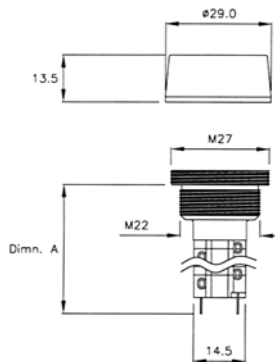

Panel Cut Out Details

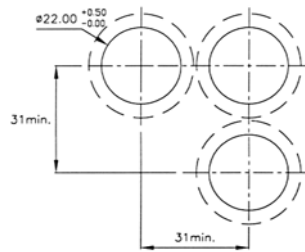





Type	Dimension A
3 Pole	44.0mm
2 Pole	36.2mm
1 Pole	28/5mm



Action	Momentary					
Bezel Option	Plastic			Metal		
Contact Option	SPST* - 1 Pole	DPST* - 2 Pole	3PST* - 3 Pole	SPST* - 1 Pole	DPST* - 2 Pole	3PST* - 3 Pole
Tyco Part Number	1478650-1	1478650-2	1478650-3	1478644-1	1478644-2	1478644-3

Action	Alternate					
Bezel Option	Plastic			Metal		
Contact Option	SPST* - 1 Pole	DPST* - 2 Pole	3PST* - 3 Pole	SPST* - 1 Pole	DPST* - 2 Pole	3PST* - 3 Pole
Tyco Part Number	1478651-1	1478651-2	1478651-3	1478645-1	1478645-2	1478645-3

Accessories

	Incandescent Bulb			Bulb Extractor
				
Volts/mA	6V, 200mA	14V, 80mA	28V, 40mA	
Tyco Part Number	1478661-1	1478661-2	1478661-3	1478662-1

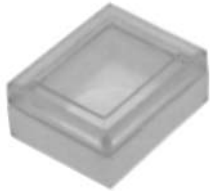
	16mm Mounting Wrench	Lens Removing Tool
		
Tyco Part Number	1478663-1	1478664-1

	Rectangular Spray Cover	Protection Cover for Square/Rectangular Switch			
					
		Square		Rectangular	
		90° Opening	180° Opening	90° Opening	180° Opening
Tyco Part Number	1478665-1	1478666-1	1478666-2	1478666-3	1478666-4

Technical Specifications

Contact Block Diagrams

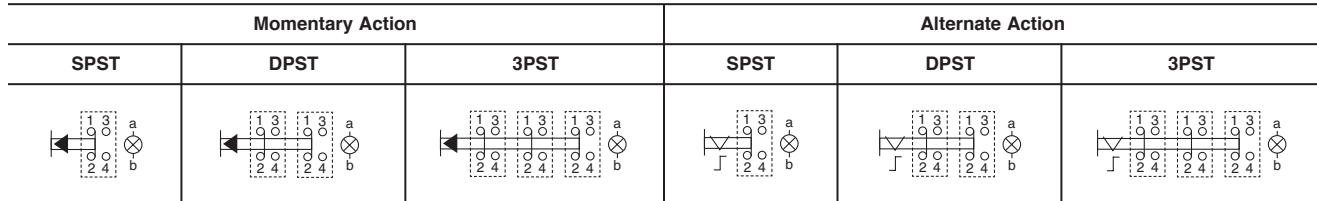

Technical Information - 16mm & 22mm

Switch System	Each Contact block has one double break snap action switching mechanism		
Switch Mode	Momentary or Alternate mode. 1-3 poles		
Contact Material	Soldering Type - Silver is standard • Socket Type - pin with golden plating		
Body Material	High grade temperature resistant thermoplastic. Contact housing molded in electrical high-grade thermosetting plastic		
Operating Level	3.0mm		
Actuating Force	2-5N depending on number of contact blocks		
Mechanical Life Time	> 2 million operations		
Electrical Life Time	Alternate Action	Momentary Action	
5A/250V AC	> 5.0 x 10 ⁴ operations	> 2.5 x 10 ⁴ operations	
4A/250V AC	> 1.2 x 10 ⁵ operations	> 6.0 x 10 ⁴ operations	
2A/250V AC	> 4.0 x 10 ⁵ operations	> 2.0 x 10 ⁵ operations	
1A/250V AC	> 8.0 x 10 ⁵ operations	> 4.0 x 10 ⁵ operations	
Initial Contact Resistance	< 10m Ω current IA AC. According to IEC-341 test I, silver contact < 15m Ω 20mV, according to IEC 341-1 test II, gold contact		
Terminal	Diameter of wire 2 x 0.8mm Diameter of standard cable 0.75mm ² max		
Electric Rating	250V AC 5A 125V AC 8A 250V DC 0.2A 24V DC 6A		
Max. Insulation Voltage	2000V, 60Hz, 1 min. between all terminals and ground		
Acceleration	> 10g in all 3 planes		
Vibration Resistance	IEC 68-2-6 test		
Soldering Heat Resistance	280°C 4 sec		
Insulation Resistance	IEC 341-1, > 1000 megaΩ 500V DC		
Panel Thickness	8mm max.		
Degree of Protection	16mm - IP 40 22mm - IP 65		
Storage Temperature	-40°C to +85°C		
Operating Temperature	-25°C to +55°C with lamp -25°C to +70°C without lamp		
Alternate Action	Push-on, push-off		